

## WATERSTOPS - HYDROPHILIC

### Dual Seal

Dual Seal is manufactured from Sodium Bentonite which swells up to 20 times its dry volume in contact with water to provide a totally watertight joint. It can be applied directly onto scabbled surfaces even in damp conditions prior to the next concrete pour. It requires no welding, adhesives or special junctions. Jointing and change of direction is simply achieved by overlapping by 50mm.

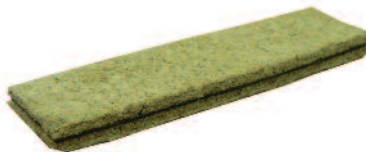

Code	Item	Roll Size Metre
DSEAL	Dual Seal (Standard)	8.00
DSEALW	Dual Seal (Saltwater Grade)	8.00



### Bentorub

Bentorub Hydros swelling Waterstop consists of bentonite clay and butyl rubber and is used for the sealing of construction joints in concrete. The system is ecological, user friendly and will remain permanently active within the joint for the expected life of the structure. As concrete cures, shrinkage will occur, with voids and small cracks appearing in the construction. When in contact with water Bentorub expands and will fill these voids or cracks thereby maintaining a watertight seal of the joint. Held in place by shot firing or with a bento-cage.



Code	Item	Size
BRUB	Bentorub	5 metre
BRUBC	Bentorub Cage	1 metre

### Swelltite

Swelltite Hydrophilic Waterstop is manufactured from a Neoprene Polymer based hydrophilic compound and high water absorbent resins. Swelltite has been specifically designed for use in sealing construction joints between pre-cast concrete units, steel and in-situ concrete. Unlike traditional waterstops, Swelltite is centrally placed and bonded flat in the joint prior to making the second pour. Activated by water, Swelltite will swell up to five times its volume and seals the passage of water by exerting pressure across the joint.



Code	Size Metre
SWT	15 metre roll
JP1	1 ltr Primer

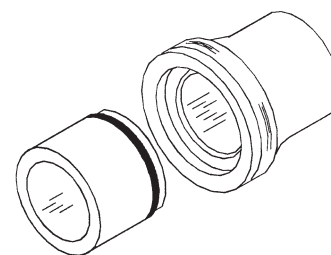

## WATERPROOFING – MEMBRANES

### Bitusheet XL

Cross laminated Heavy Duty H.D.P.E. membrane coated with self bonding polymer modified bitumen.

For use in below ground structures as external tanking and as a roofing membrane in covered concrete reservoirs.

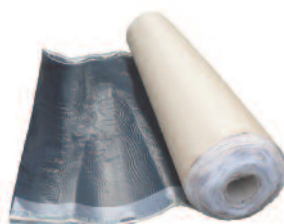

Code	Item	Unit Size
BSXL	Bitusheet XL	1.05 x 19.05m

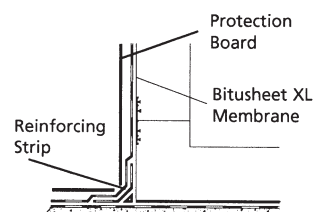

For prices please contact our sales office

Tel: 01223 862230 Fax: 01223 440246 Web: [www.informuk.co.uk](http://www.informuk.co.uk) Email: [general@informuk.co.uk](mailto:general@informuk.co.uk)

## Dual Seal Membrane

Dual Seal is a high performance self swelling, self healing waterproofing membrane comprising of a thick, tough, high density polyethylene sheet laminated Bentonite granules. It provides a totally watertight barrier in below ground concrete construction, including basements, underground car parks, plant rooms, access tunnels etc.



Code	Item	Unit Size
DSM	Dual Seal Membrane	1.22 x 7.32m



## Bitusheet Primer

Bitusheet Primer is a high tack primer for use on vertical walls prior to the fixing of Bitusheet XL. It is not required on horizontal surfaces. It is applied directly to the concrete by brush.



Code	Item	Unit Size
BSP5	Bitusheet Primer	5 ltr
BSP25	Bitusheet Primer	25 ltr
BSM	Bitusheet Mastic	25 ltr
BF48	48/48mm Fillet	metre

## Bitusheet Tapes

A range of tapes are available for the joining of the waterproof membranes. Single sided tapes are generally used for joint sealing of membranes, whilst double sided tapes are used on the over-laps where extra sealing is required.



Code	Item	Unit Size
XRLS10	Reinforcing Tape	100mm x 20m
XRLS15	Reinforcing Tape	150mm x 20m
XRLS30	Reinforcing Tape	300mm x 20m
BT050	Double Sided Tape	50mm x 15m
BT075	Double Sided Tape	75mm x 15m
BT100	Double Sided Tape	100mm x 10m
BT150	Double Sided Tape	150mm x 15m
BT300	Double Sided Tape	300mm x 15m

## Protection Boards

Protection Boards in the main are used for the protection of membranes from site trafficking and on back filling against vertical surfaces. The different types of boards provide varying levels of protection to suit site conditions. Our sales office will be able to recommend the correct board for your type of application.

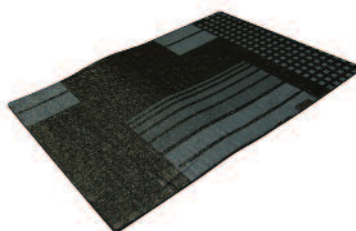

Code	Item	Unit Size
BPB3	3mm Bituminous	2.13m x 1.22m
BPB6	6mm Bituminous	2.13m x 1.22m
BPCB3	3mm Bitcoat	1.85m x 1.25m
BSPB15	1.5mm Bitusheet HD	1m x 2m
BSPB30	3mm Bitusheet HD	1m x 2m
PPB2	2mm Polypropylene	1m x 2m